

**SECOND FLOOR PLAN - 1:100**

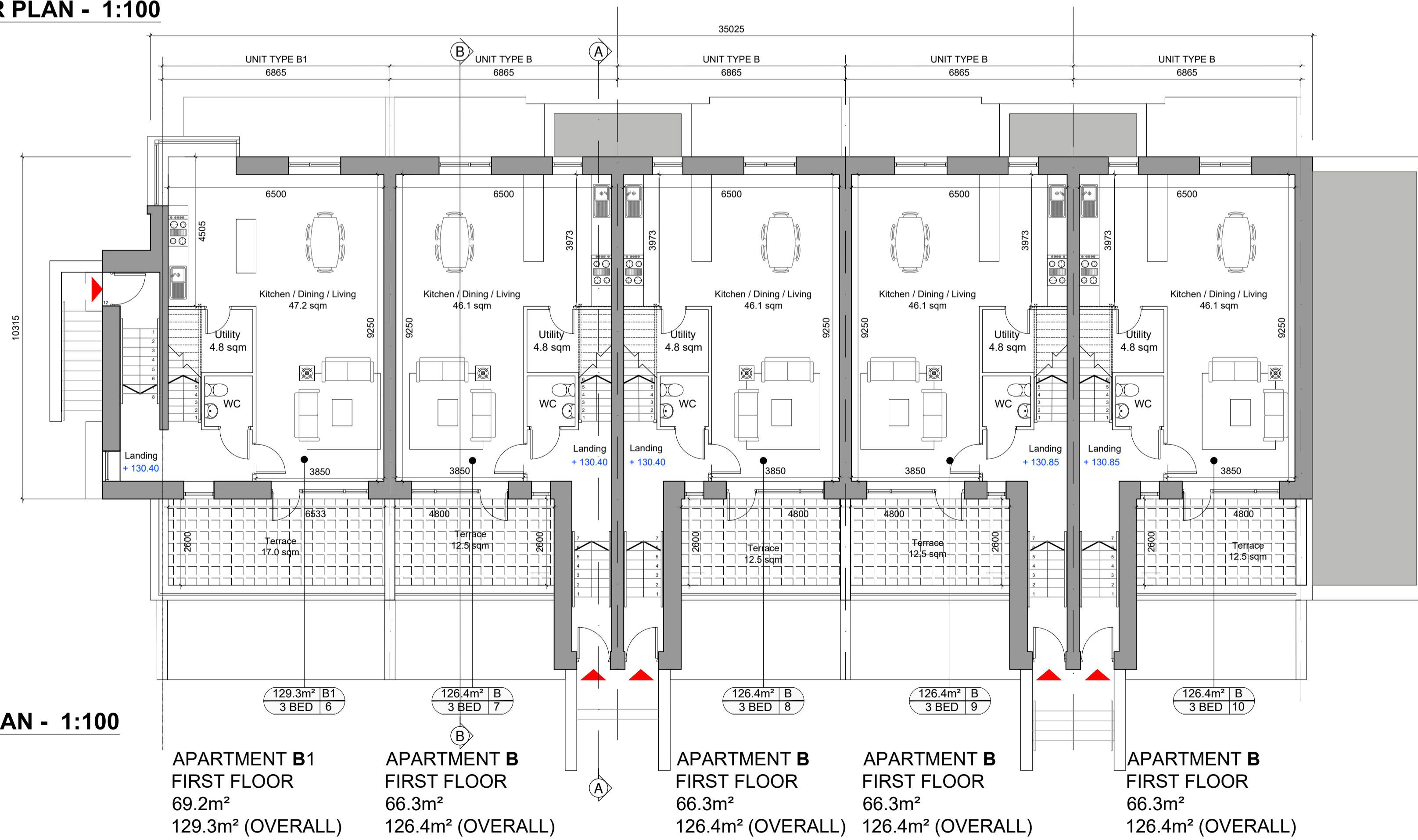

**FIRST FLOOR PLAN - 1:100**



**DUPLEX BLOCK D**

**LEGEND**

▼ Access & Stair Core Entrance

**SCHEDULE OF ACCOMMODATION**

UNIT TYPE A	- 2 BED -	4 No. - ( 82.9 Sq.m)
UNIT TYPE A1	- 2 BED -	1 No. - ( 85.8 Sq.m)
UNIT TYPE B	- 3 BED -	4 No. - (129.3 Sq.m)
UNIT TYPE B1	- 3 BED -	1 No. - (126.4 Sq.m)

**TOTAL - 10 No. Units**

**UNIT MIX QUANTITIES**

2 Bed	5 Units
3 Bed	5 Units
<b>Total</b>	<b>10 Units</b>

**NOTES:**

DO NOT SCALE FROM DRAWINGS. WORK TO FIGURED DIMENSIONS ONLY. ARCHITECT TO BE NOTIFIED OF ALL DISCREPANCIES.

REVISIONS		
DATE	DESCRIPTION	No.

<p>M<sup>C</sup>CROSSAN O'ROURKE MANNING ARCHITECTS</p>	PROJECT TITLE:	Residential Development @ Boherboy Lands	DATE:	Feb '21	DRAWN BY:	SM
	DRAWING TITLE:	Duplex Block D	SCALE:	1:100@A1	REVISION:	*
		First & Second Floor Plans	JOB NO.:	20002	DRAWING NO.:	DUPD02
		1 Grantham Street, Dublin 8, D08 A8P9, Ireland. Tel: 01-4788700 Fax: 01-4788711 E-Mail: smc@mcorm.com				